



## 1 Trinity Close

, Scarborough, YO11 2TG

**£850 PCM**



This three bedroom semi-detached house has been recently modernised and is situated within walking distance of the South Bay, Town Centre and the local shops of Falsgrave. It comprises a lounge, kitchen, WC, three bedrooms and a bathroom. The property also benefits from a garage, garden and gas central heating, as well as off street parking.

Children accepted, pets considered. Strictly no smoking.

EPC rating C





FRONT DOOR

leading to

HALLWAY

leading to

LOUNGE

with stone fire place, radiators, uPVC windows and door leading to outside

KITCHEN

with a range if base and wall units, stainless steel sink unit, plumbing for washing machine, space for fridge, window and radiator

WC

with WC, hand basin and radiator

UPSTAIRS TO

BEDROOM ONE

with radiator and uPVC window

BEDROOM TWO

with radiator and uPVC window

BEDROOM THREE

with radiator and uPVC window

BATHROOM

with three piece suite, shower over the bath, uPVC window and radiator

OUTSIDE

garage and gardens

DIRECTIONS

SATNAV - postcode YO11 2TG  
what3words - ///invest.bucket.mute

UTILITIES

COUNCIL TAX - Band C (North Yorkshire Council)  
GAS AND ELECTRIC CHARGES - TBC  
WATER CHARGES - TBC

REFERENCING

TO APPLY WE REQUIRE PHOTO ID, PROOF OF INCOME, PROOF OF ADDRESS AND A HOLDING DEPOSIT OF £195.00 (PLEASE NOTE: THIS WILL BE WITHHELD IF ANY RELEVANT PERSON (INCLUDING ANY GUARANTORS) WITHDRAW FROM THE TENANCY, FAIL A RIGHT TO RENT CHECK, PROVIDE MATERIALLY SIGNIFICANT FALSE OR MISLEADING INFORMATION, OR FAIL TO SIGN THEIR TENANCY AGREEMENT (AND/OR GUARANTOR AGREEMENT) WITHIN 15 CALENDAR DAYS (OR OTHER DEADLINE FOR AGREEMENT AS MUTUALLY AGREED IN WRITING).

AFTER PASSING THE RENT AND DEPOSIT DUE ON THE DAY OF SIGNING THE AGREEMENTS ARE:  
RENT £850.00  
HOLDING DEPOSIT -£195.00  
DEPOSIT £980.00

TOTAL £1635.00

Area Map



Floor Plans

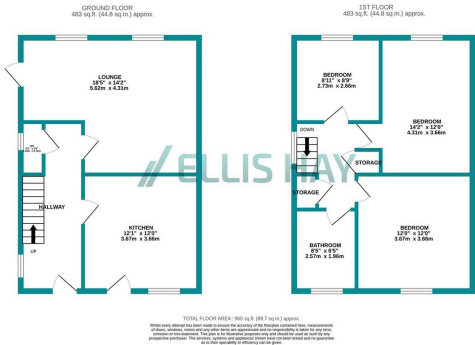

Energy Efficiency Graph

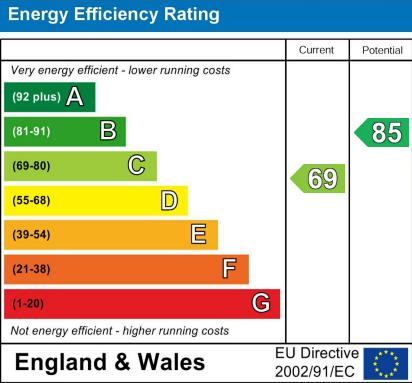

Ellis Hay for themselves, for any joint agents and for the vendors or lessors of this property whose agents they are, give notice that (all the particulars are set out as a general outline only for the guidance of intending purchasers or lessees, and do not constitute, nor constitute part of, an offer or contract; (ii) all descriptions, dimensions, references to condition and necessary permissions for use and occupation, and other details are given in good faith and are believed to be correct but any intending purchasers or tenants should not rely on them as statements or representations of fact but must satisfy themselves by inspection or otherwise as to the correctness of each of them; (iii) no person in the employment of Ellis Hay, has any authority to make or give any representation or warranty whatever in relation to this property